

## Mod kit for N64 controller + Joystick

\*Please handle it with care. We are not responsible for any damage caused in use.

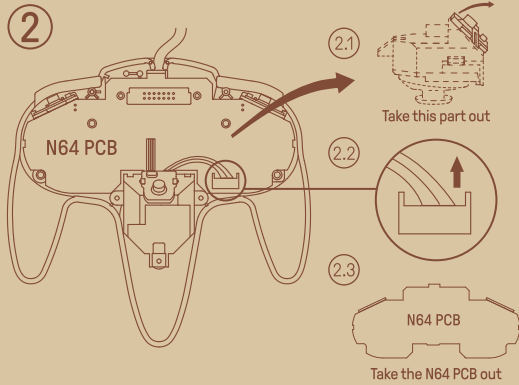
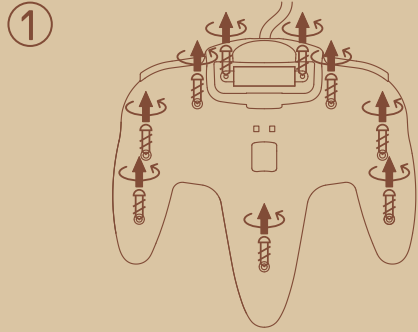

\*Please assemble the membrane pad of the original N64 controller on the 8BitDo PCB.

\*请将原手柄导电硅胶安装到 8BitDo PCB 板上。

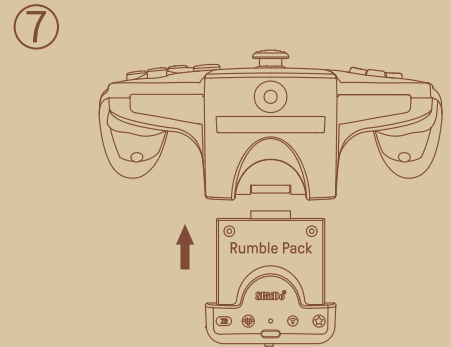
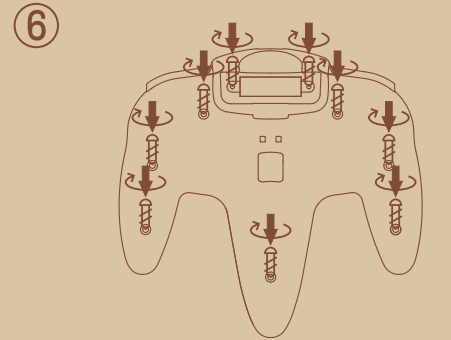
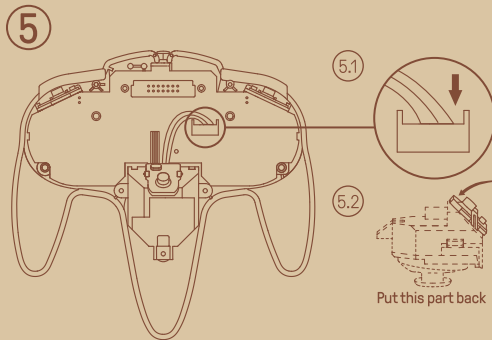
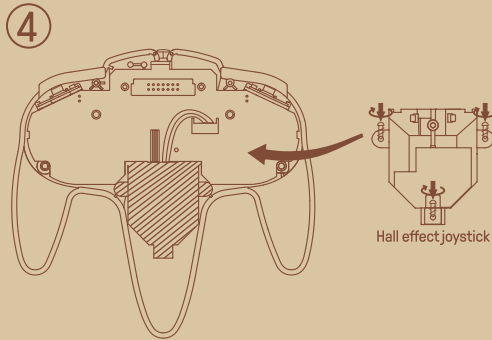
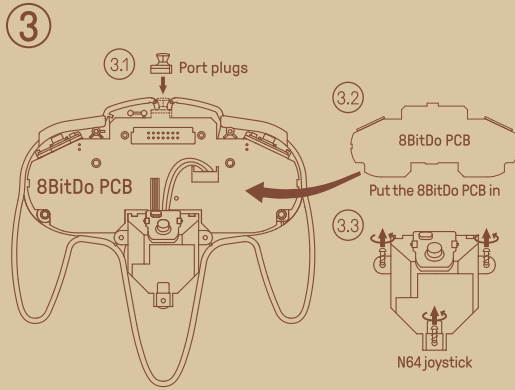

## instruction manual

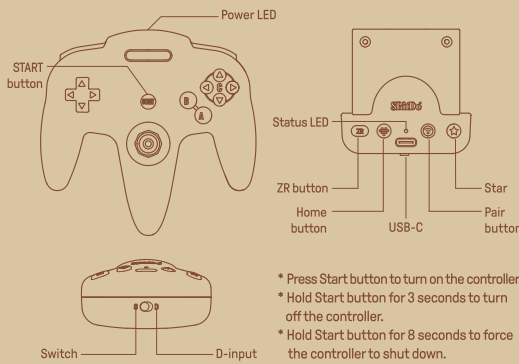

\* Press Start button to turn on the controller.  
\* Hold Start button for 3 seconds to turn off the controller.  
\* Hold Start button for 8 seconds to force the controller to shut down.

## Switch

\* Please ensure your Switch system is the latest version.

### Bluetooth

1. Turn the mode switch to [S].
2. Press Start to turn on the controller.
3. Hold pair button for 3 seconds to enter its pairing mode, LED starts to blink rapidly. (This is required for the very first time only)
4. Go to your Switch Home page to click on [Controllers], then click on [Change grip/order] and wait for the connection.
5. LED becomes solid when the connection is successful.

### Wired Connection

- \* Go to System Setting > Controllers and Sensors > turn on Pro Controller Wired Communication
1. Turn the mode switch to [S].
  2. Connect the controller to your Switch dock via USB cable.
  3. Wait till the controller is successfully recognized by your Switch to play

## Android / Windows

### Bluetooth

1. Turn the mode switch to [D].
2. Press Start to turn on the controller.
3. Hold pair button for 3 seconds to enter its pairing mode, LED starts to blink rapidly. (This is required for the very first time only)
4. Go to your Android/Windows device's Bluetooth setting and pair with [8BitDo N64 Modkit].
5. LED becomes solid when the connection is successful.

## Wired Connection

1. Turn the mode switch to [D].
2. Connect the controller to your Android/Windows device via USB cable, then wait till the controller is successfully recognized by your Android/Windows device to play.

## Turbo

- \* D-Pad, joysticks, Star button are not supported.
- \* Star button equals to screenshot when connected to Switch.
- \* Hold the button you would like to set turbo functionality to, then press the star button to activate/deactivate its turbo functionality.

## Battery

About 8 hours of play time with a 500mAh built-in battery pack, rechargeable with 1 to 2 hours charging time.

### LED indicator status:

Charging	—————>	LED stays solid
Fully charged	—————>	LED light out
Low battery	—————>	LED blinks

- \* It will automatically shut down if it is not connected within 1 minute or if there is no operation within 15 minutes after startup.
- \* It will not automatically shut down when it is on wired connection.

## Support

\* Please visit [support.8bitdo.com](http://support.8bitdo.com) for further information & additional support.

## Switch

\* Switch 主机系统已更新到最新版本

### 蓝牙连接

1. 将模式开关移动到 [S] 位置。
2. 按下 [START 键] 开启手柄。
3. 按住 [配对键] 约 3 秒进入配对状态, 状态指示灯快速闪烁。(仅首次连接时需要配对)
4. 打开 Switch 主机 [手柄] - [更改握法 / 顺序], 等待手柄连接。
5. 连接完成后, 状态指示灯常亮。

### 有线连接

- \* 使用前请确保 [设置] - [手柄与感应器] - [Pro 手柄的有线连接] 已开启。
1. 将模式开关移动到 [S] 位置。
  2. 使用 USB 线将手柄连接到 Switch 主机的 USB 端口, 等待系统识别完成后即可使用。

## Android / Windows

### 蓝牙连接

1. 将模式开关移动到 [D] 位置。
2. 按下 [START 键] 开启手柄。
3. 按住 [配对键] 约 3 秒进入配对状态, 状态指示灯快速闪烁。(仅首次连接时需要配对)
4. 打开 Android / Windows 设备蓝牙, 搜索 [8BitDo N64 Mod kit] 连接。
5. 连接完成后, 状态指示灯常亮。

### 有线连接

1. 将模式开关移动到 [D] 位置。
2. 使用 USB 线将手柄连接到 Android / Windows 设备的 USB 端口, 等待系统识别完成后即可使用。

## 连发

- \* 方向键、摇杆不支持连发。
- \* 连接 Switch 时星号键为截图, 不支持连发。
- 按住需要设置连发的功能键, 再按下 [星号键] 可开启 / 关闭连发。

## 电源

内置 500mAh 可充电式锂电池, 充电时间约 1-2 小时, 可持续使用约 8 小时。

### 电源指示灯状态

正在充电	—————>	红灯常亮
充电完成	—————>	红灯熄灭
电量不足	—————>	红灯闪烁

- \* 开机后 1 分钟未连接或连接后 15 分钟无操作会自动关机。
- \* 有线连接时不会自动关机。

## 技术支持

\* 请访问 [support.8bitdo.cn](http://support.8bitdo.cn) 了解详细信息。

## 使用说明



- \* 开机: 按下 START 键。
- \* 关机: 按住 START 键 3 秒。
- \* 强制关机: 按住 START 键 8 秒。