

Instructions - SN30 Modkit

8BitDo®

* Please handle it with care.
We are not responsible for any damage caused in use.

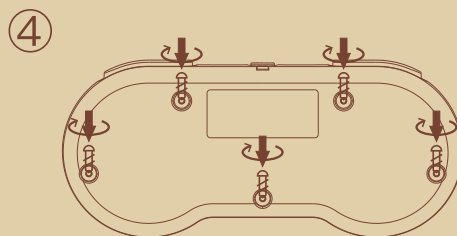
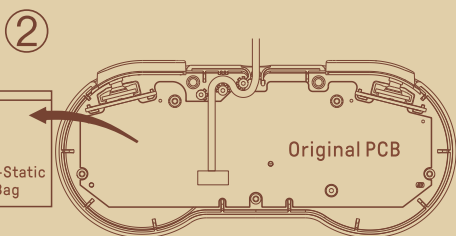
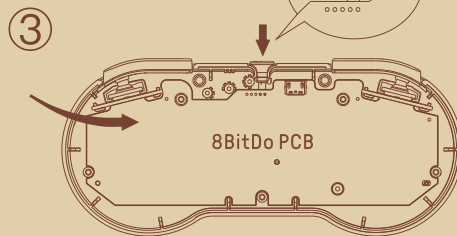
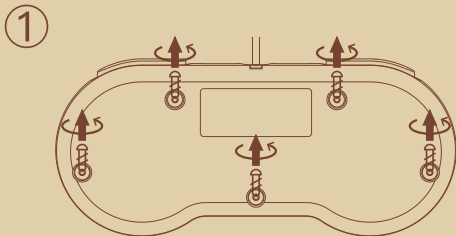

Anti-Static Bag

Original PCB

8BitDo PCB

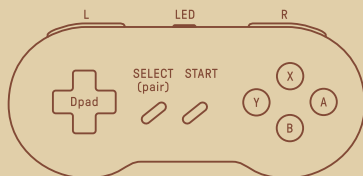

Press START to turn on the controller
Press and hold START for 3 seconds to turn off the controller
Press and hold START for 8 seconds to force turn off the controller

Bluetooth connection

Switch

1. Press START+Y to turn on the controller. LED will blink 4 times per cycle.
 2. Press and hold SELECT for 3 seconds to enter pairing mode. LED will rapidly blink.
 3. Go to your Switch Home Page to click on Controllers, then click on Change Grip/Order and wait for controller to sync up. LED will become solid when connection is successful.
 4. Controller will auto reconnect to your Switch with the press of START once it has been paired.
- When connected to your Switch, DOWN+SELECT = Switch HOME button.

Android

1. Press START+B to turn on the controller, LED will blink once per cycle.
2. Press and hold SELECT for 3 seconds to enter pairing mode. LED will rapidly blink.
3. Go to your Android device's Bluetooth setting, pair with [8BitDo SN30 Modkit]. LED will become solid when connection is successful.
4. Controller will auto reconnect to your Android device with the press of START once it has been paired.

Windows

1. Press START+X to turn on the controller, LED will blink twice per cycle.
2. Press and hold SELECT for 3 seconds to enter pairing mode. LED will rapidly blink.
3. Go to your Windows device's Bluetooth setting, pair with [8BitDo SN30 Modkit]. LED will become solid when connection is successful.
4. Controller will auto reconnect to your Windows device with the press of START once it has been paired

macOS

1. Press and hold START+A to turn on the controller, LED will blink 3 times per cycle.
2. Press and hold SELECT for 3 seconds to enter pairing mode. LED will rapidly blink.
3. Go to your macOS device's Bluetooth setting, pair with [Wireless Controller]. LED will become solid when connection is successful.
4. Controller will auto reconnect to your macOS device with the press of START once it has been paired.

8BitDo Retro Receivers and USB Adapter

1. Press START+B to turn on the controller, LED will blink once per cycle.
2. Press both PAIR button on the receiver/Adapter and SELECT on the controller to sync them.
3. Both LEDs on the receiver/Adpter and controller will become solid when connection is successful.

Button Mapping

Press and hold HOT KEY for 3 seconds to map DPAD and other buttons, LED will blink once in red when successful:

SELECT + UP: DPAD = DPAD
SELECT + LEFT: DPAD = LEFT JOYSTICK
SELECT + RIGHT: DPAD = RIGHT JOYSTICK
SELECT + DOWN: Swap A-B and X-Y

* Works only before connecting anything.

Battery

Status - LED Indicator
Low battery mode - Red LED blinks
Battery charging - Red LED stays solid
Battery fully charged - LED turns off

- * Built-in 230 mAh Li-ion with 10 hours of play time.
- * Rechargeable via USB cable with 30 minute charging time.

Support

Please visit <http://support.8bitdo.com/> for further information and additional support.